

## FC-W01 Programmable Gateway



### Overview

All the serial ports of FC-W01 series of programmable gateways support Modbus communication protocol, through programming to make the serial ports be configured as a Modbus primary station or the primary station of other agreements or slave stations. It is with all networking equipments to compose a seamless, closed-loop unity. It's simple and flexible configuration and high reliability can save your valuable time and existed investments, especially in the network construction, it can greatly improve the core competitiveness of your product, highlighting the programmable features.

### Product Features

1. Use 32 bit ARM processor design, with abundant storage space.
2. Communication ports are with full photoelectric isolation design, and isolate the signal lines, power, ground, and with lightning and surge protection
3. Supports IEC61131-3 standard programming environment
4. Supports MODBUS TCP / MODBUS RTU gateway function
5. Supports IEC60870-5-104 protocol/ MODBUS RTU gateway function
6. Supports serial port with free port programming, supports CAN protocol free programming
7. Wide applications: manufacturing industry, process control, communications, instrumentation, automobile, ship, military equipment, etc.

### Technical Parameters



Communication Rate	RS232/RS485 Communication rate 300~115200bps; provides 10M/100M Ethernet interface
Communication Serial Port	3 ways of RS232/RS485 isolation communication serial port,2 ways of CAN port
Power Supply	Double lines DC9~36V/AC90~264V hot standby redundancy (optional)
Working Environment	Working temperature: -25℃~70℃, humidity: 5%-95%RH no condensation
Protection Grade	IP20

## Dimension Figure

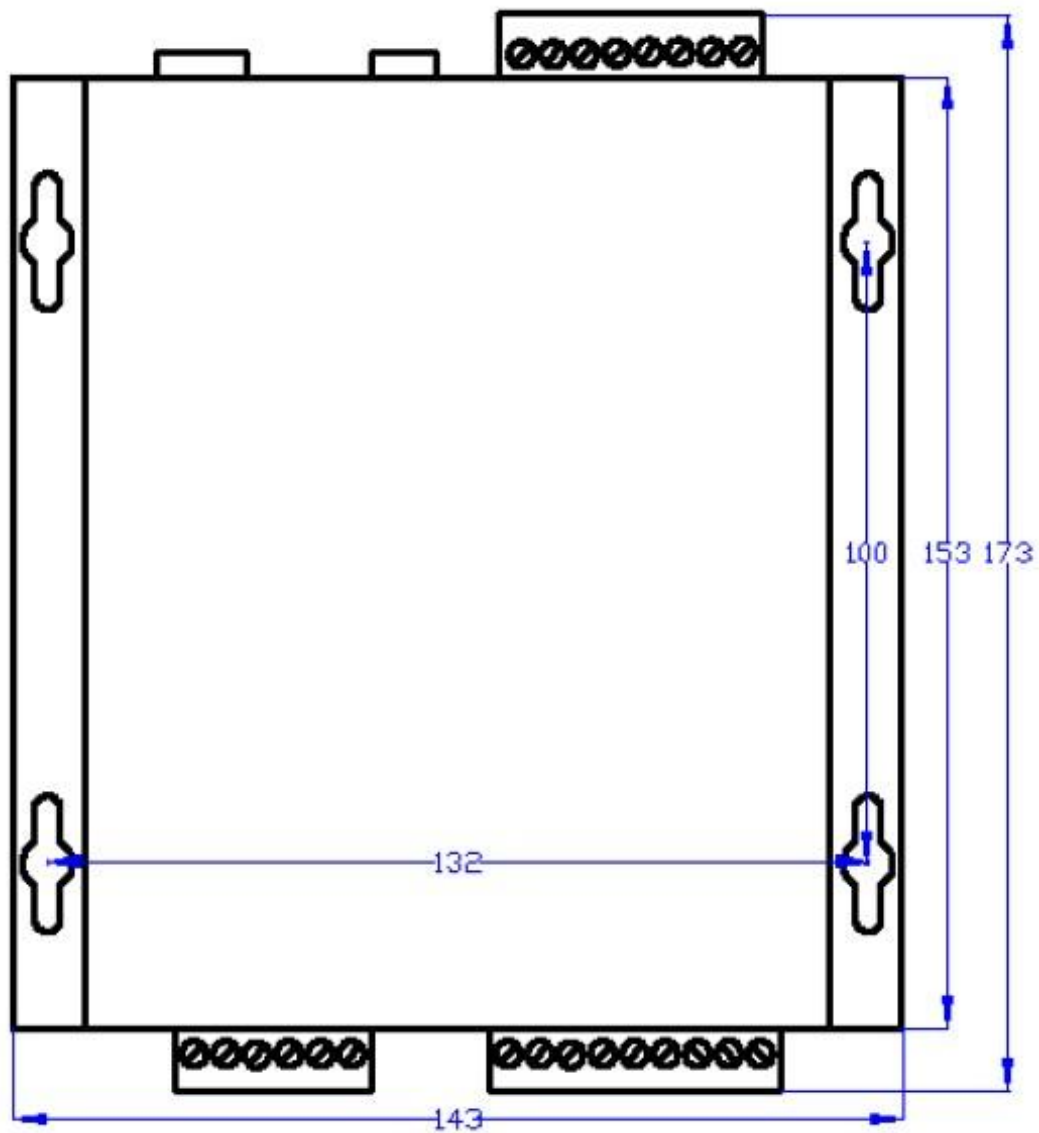

## Ordering Model

Basic Model	Mode of Power Supply	Working Power Supply	Serial Port	Illustration
FC-W01				Programmable gateway
	O			Single power supply
	D			Duplex power supply
		P1		9-36V
		P2		AC220V
			SP1	□RS485 □RS232
			SP2	□RS485 □RS232
			SP3	□RS485 □RS232